

PRODUCT FEATURES

- Ultrafast Reverse Recovery Time
- Soft Reverse Recovery Characteristics
- Low Reverse Recovery Loss
- Low Forward Voltage
- High Surge Current Capability
- Low Leakage Current



APPLICATIONS

- Inversion Welder
- Uninterruptible Power Supply
- Plating Power Supply
- Ultrasonic Cleaner and Welder
- Converter & Chopper
- PFC

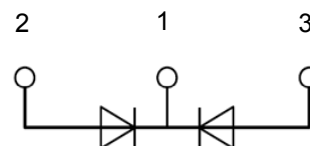

ABSOLUTE MAXIMUM RATINGS ($T_C=25^{\circ}\text{C}$ unless otherwise specified)

Symbol	Parameter/Test Conditions		Values	Unit
V_R	Maximum D.C. Reverse Voltage		1700	V
V_{RRM}	Maximum Repetitive Reverse Voltage			
$I_{F(AV)}$	Average Forward Current	$T_C=70^{\circ}\text{C}$, Per Diode	100	A
$I_{F(RMS)}$	RMS Forward Current	$T_C=70^{\circ}\text{C}$, Per Diode	140	
I_{FSM}	Non Repetitive Surge Forward Current	$T_J=45^{\circ}\text{C}$, $t=10\text{ms}$, Sine, peak value	750	
		$T_J=45^{\circ}\text{C}$, $t=8.3\text{ms}$, Sine, peak value	825	
I^2t	For Fusing	$T_J=45^{\circ}\text{C}$, $t=10\text{ms}$, Sine, peak value	2813	A^2S
		$T_J=45^{\circ}\text{C}$, $t=8.3\text{ms}$, Sine, peak value	2824	
P_D	Power Dissipation		320	W
T_J	Junction Temperature		-40 to +150	$^{\circ}\text{C}$
T_{STG}	Storage Temperature Range		-40 to +125	$^{\circ}\text{C}$
V_{isol}	Isolation Breakdown Voltage	AC, 50Hz(R.M.S), $t=1\text{minute}$	4000	V
Torque	Module to Sink	Recommended (M6)	3~5	Nm
Torque	Module Electrodes	Recommended (M6)	3~5	Nm
R_{thJC}	Junction to Case Thermal Resistance(Per Diode)		0.39	$^{\circ}\text{C}/\text{W}$
Weight			160	g

MacMic Science & Technology Co., Ltd.

Add: #18, Hua Shan Zhong Lu, New District, Changzhou City, Jiangsu Province, P. R. of China

Tel.: +86-519-85163708 Fax: +86-519-85162291 Post Code: 213022 Website: www.macmicst.com

MMF100S170DK2B

ELECTRICAL CHARACTERISTICS ($T_C=25^\circ\text{C}$ unless otherwise specified)

Symbol	Parameter/Test Conditions	Min.	Typ.	Max.	Unit
I_{RM}	Maximum Reverse Leakage Current	$V_R = 1700\text{V}$		100	μA
		$V_R = 1700\text{V}, T_J = 125^\circ\text{C}$		10	mA
V_F	Forward Voltage	$I_F=100\text{A}$		1.8	V
		$I_F=100\text{A}, T_J=125^\circ\text{C}$		1.9	
t_{rr}	Reverse Recovery Time ($I_F = 1\text{A}, dI_F/dt = -200\text{A}/\mu\text{s}, V_R = 30\text{V}$)		110		ns
t_{rr}	Reverse Recovery Time	$I_F=100\text{A}, V_R=850\text{V},$		1240	ns
I_{RRM}	Maximum Reverse Recovery Current	$dI_F/dt = -200\text{A}/\mu\text{s}$		32	A
t_{rr}	Reverse Recovery Time	$I_F= 100\text{A}, V_R =850\text{V},$		1850	ns
I_{RRM}	Maximum Reverse Recovery Current	$dI_F/dt = -200\text{A}/\mu\text{s}, T_J=125^\circ\text{C}$		34.5	A
t_{rr}	Reverse Recovery Time	$I_F= 100\text{A}, V_R =850\text{V},$		645	ns
I_{RRM}	Maximum Reverse Recovery Current	$dI_F/dt = -1000\text{A}/\mu\text{s}, T_J=125^\circ\text{C}$		102	A

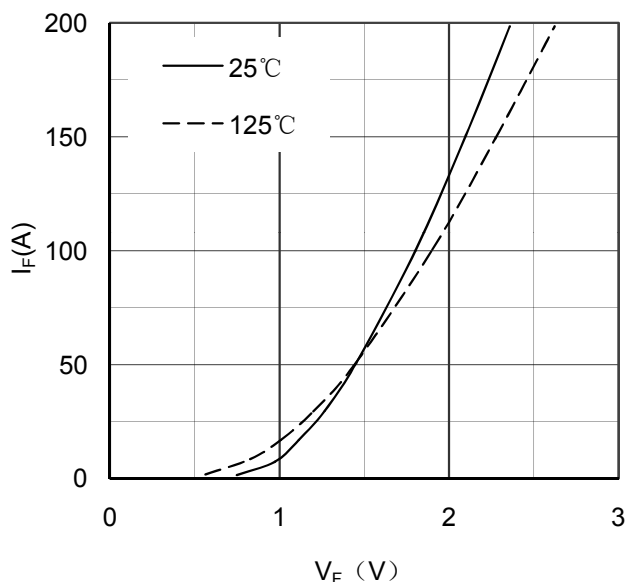

Figure 1. Forward Voltage Drop vs Forward Current

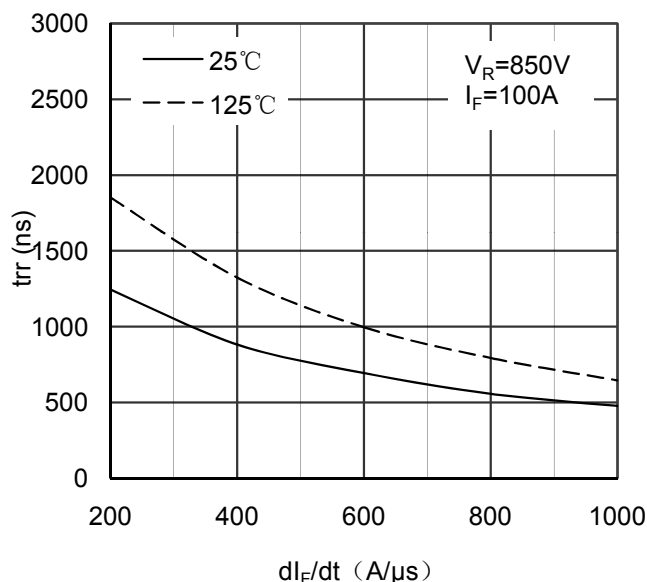

Figure 2. Reverse Recovery Time vs dI_F/dt

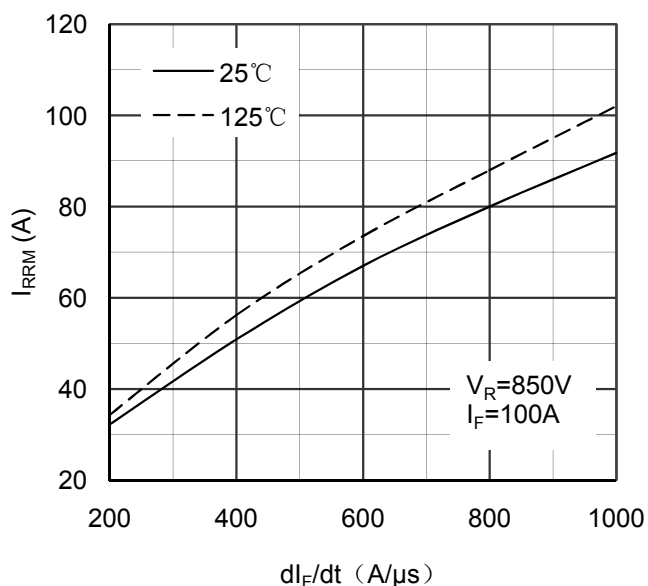

Figure 3. Reverse Recovery Current vs dI_F/dt

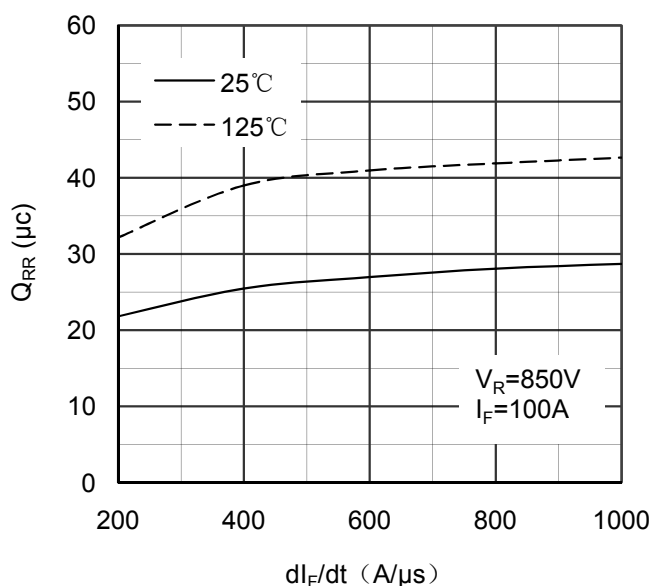

Figure 4. Reverse Recovery Charge vs dI_F/dt

MMF100S170DK2B

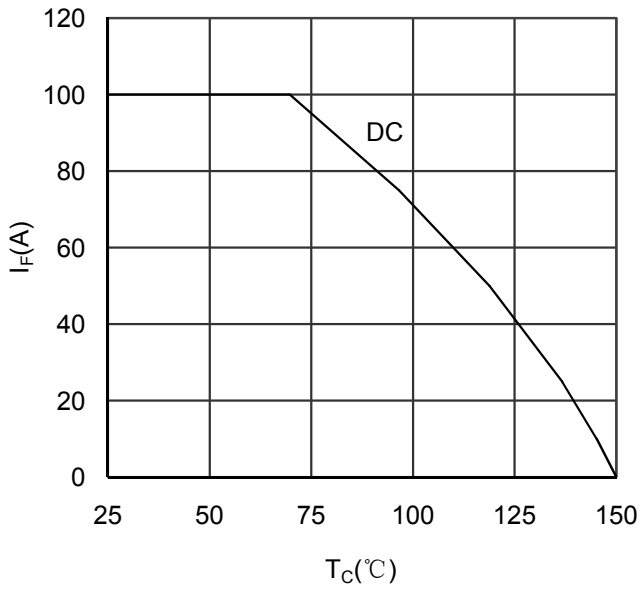

Figure 5. Forward current vs Case temperature

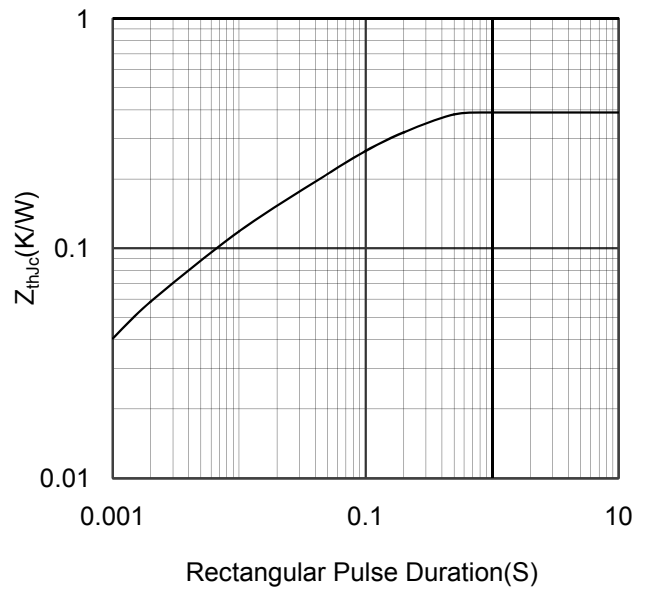
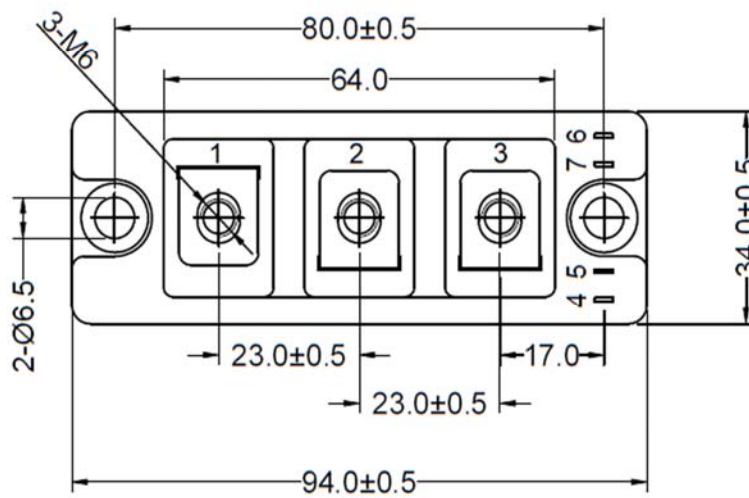
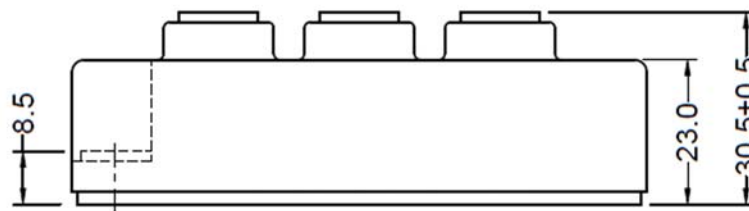

Figure 6. Transient Thermal Impedance



Dimensions in (mm)

Figure 7. Package Outline